

# 10 CARD CUTTING FUNN GUIDE

by Mary Gunn

02/29/16

① You will need a 12" x 12" patterned, painted, or stamped piece of cardstock

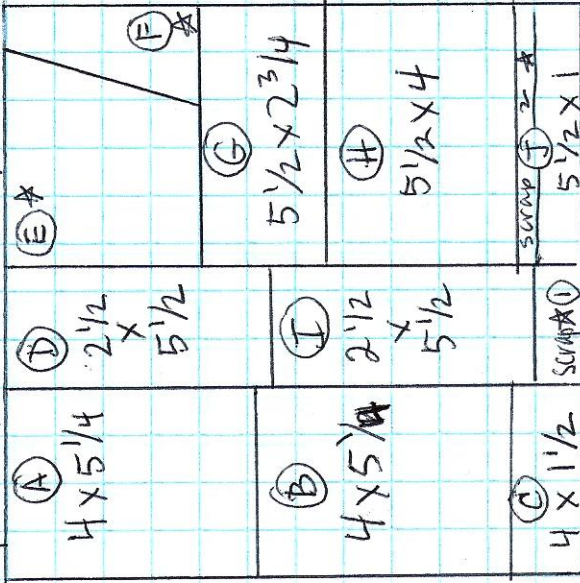

② Coordinating mat cardstock

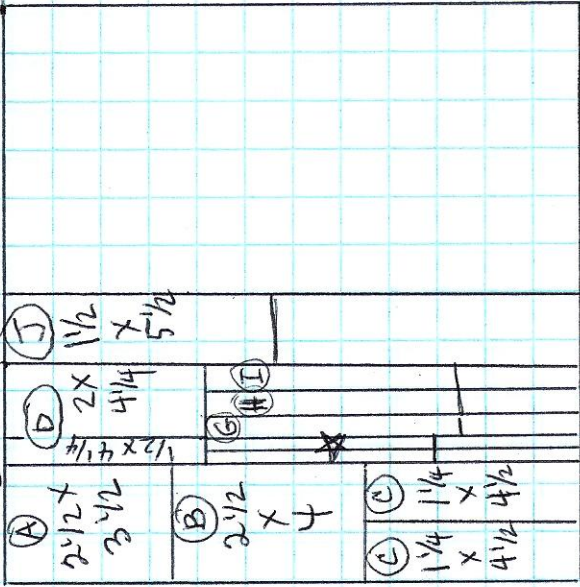

③ A 2nd Coordinating Mat Cardstock

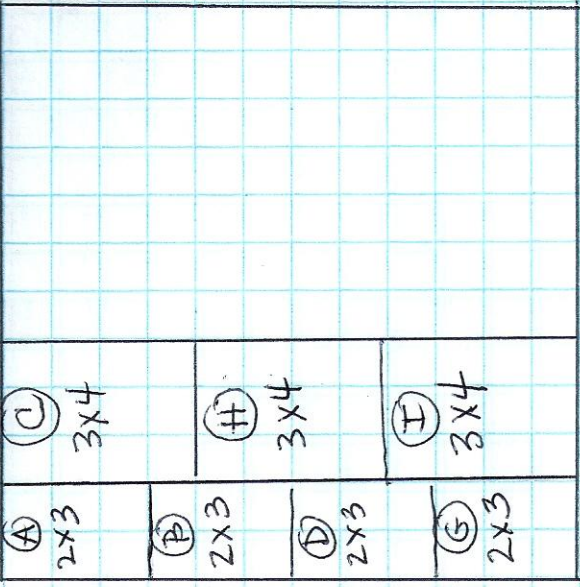

Mat 1

\* E + F = 1/4 x 4 1/2 = trim

G = 1/2 x 5 1/2

H = 1/2 x 5 1/2

I = 1/2 x 5 1/2

Mat 2

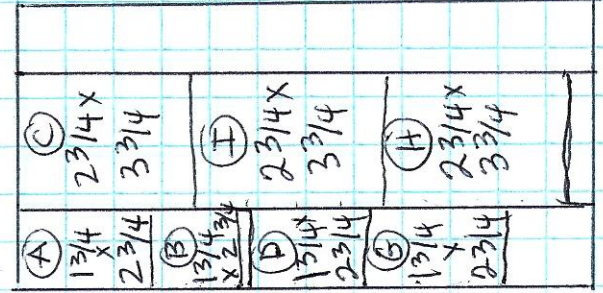

Plus circles for E & F  
Used 1/2" white circles

You will also need 10 white clay Card bases, I suggest # x254 50 cards + envelopes 4 1/4" x 5 1/2" (\$14.95)